

Operation manual

Please read the manual before operating this product.

JUSTICE SMART WATCH



Model / Modele: 731023
IC: 22563-731023

Model / Modele: 732058
IC: 22563-731023

Model / Modele: 731933
IC: 22563-731023

Compatible with all Bluetooth® enabled devices

The Bluetooth® word mark and logos are registered trademarks owned by the Bluetooth SIG, Inc.



Download your free health app: Lefun Health

Download on:

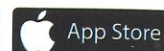

1. Introduction

Congratulations, and thank you for choosing Justice Smart Watch. This manual will help you operate the Justice Smart Watch, but first you should familiarize yourself with the Bluetooth® functionality of your mobile phone or smart device before using the Justice Smart Watch.

Safety Rules

- 1 Please follow the rules depicted in this manual closely to ensure your safety. Before using the product, we would strongly encourage you to read through this user manual.
- 2 Be wary of any edges, uneven surfaces, metal parts, accessories and its packaging to prevent any possible injury or damage.
- 3 Do not modify, repair or dismantle the product. Doing so may result in fire, electric shock, complete breakdown of the product, etc. All of which are not covered under warranty.
- 4 Do not use any diluent or volatile liquid to clean the product.
- 5 Do not use the product in a hazardous location.

2. Package Contents

- Smart Watch
- Instruction Manual

3. Product Diagram



4. How To Use

Charge your Smart Watch completely prior to setup

Remove the smart watch from the package, locate the charging port built into the screen by pulling off the band from one side. Insert the USB end of the screen into a wall charger or PC and the Smart watch will start to charge. Please allow up 2-3 hours to charge fully the first time. After a full charge, disconnect the screen from the wall charger or PC and the smart watch will return to the time display. Now you can place the band back over the charging port and be sure it's nice and secure.

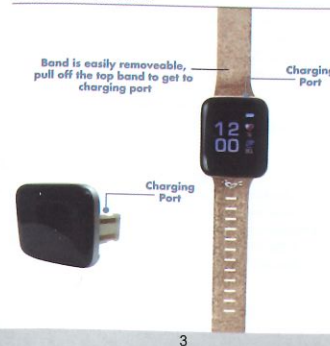

How to setup your smart watch:

Install the Lefun Health APP to your smart phone/Tablet from your designated APP store. The APP can be found in both the Apple APP Store or the Google Play store. The APP will look like the icon shown here.



Please note the Smart Watch will only display the correct time and date after it's been synced with the Lefun Health APP

Connecting the Smart Watch to the Lefun Health APP

Turn your devices Bluetooth settings to the "ON" position. Note you will not connect the Smart Watch in your Bluetooth settings. The Smart watch must be connected through the Lefun Health APP only. Tap the menu icon on the top left-hand corner, then tap on "unconnected", on the next screen tap on "Search" and then choose "SmartWatch". After selecting the smart watch, the APP will go back to the main screen and it will show connected and it will start to synchronize the data on the watch to the APP. Once the data has been synchronized correctly, the correct time and date will be displayed on the watch in military hours to change the time display to 12hrs, see the next step under Personal settings.

Menu Button:



Bluetooth Connect or Disconnect



Personal Settings:

- The Smart Watch must be paired to the APP in order to save your personal settings.
- Tap on "MY DATA" on the bottom right hand corner of the APP, then select Personal Data.
- First, it's best to choose the TIME SYSTEM and set it to 12Hour for the USA or 24hr for military time. Once you select 12hour for the USA the time will be set according to your smart devices time.
- Second thing to do is to select UNIT SYSTEM; for the USA select Feet; inches; lb. and for Canada / Europe select cm; kg.
- Once these 2 steps are completed you can then start and fill in the balance of the information required, including your Name, Gender, Height, Weight, and Birthday.

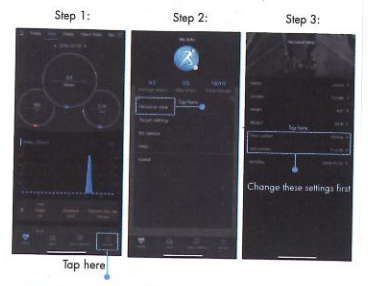

Smart Watch Functions:

- Tap on the function key on the screen in order to wake up or activate the screen. Or Raise or turn your wrist and the screen will activate by itself.
- Keep tapping the circle to switch between functions and menus on your smart watch.



How to use the Menu and Features on your smart watch:

- Tap the function key on the screen to switch through the below menu and features.

- 1) Clock: Time and date display, and battery percentage.
- 2) Steps: Number of Steps taken, and calories burned.
- 3) Sports Mode: Press and hold the function key on the screen to activate this feature, then tap the screen to switch between the multiple sports modes including: Run; Badminton; Climb; Ride; once you get to the mode you want press and hold the screen to activate that function. To Pause, Stop or Return to the previous menu tap the screen and then press and hold the function key on the option you want to choose.
- 4) BPM: once the watch is set to the Blood Pressure Monitor screen the smart watch will automatically start to record your blood pressure.
- 5) MMHG: This stands for millimeters of Mercury and is also used to measure pressure, once on this feature the smart watch will automatically start to record your mmHG.

6) SP02: This stand for the estimated amount of oxygen found in your blood, once on this feature the smart watch will automatically start to record your SP02.

7) Find Phone: The smart watch must be connected to the Bluetooth settings on your smart device for this feature to work. To activate this feature press and hold the function key on the screen and you should start to hear an emergency signal on your smart device.

8) Messages: Press and hold the function key to activate your messages. Then tap on the screen to switch through all your messages, including Texts, What's APP, Facebook, Twitter, LinkedIn and more. Only a short notification will be displayed. Please note the entire message will not be visible on the smart watch.

9) About: This screen will show you the software version you are using and is only required if you are having technical difficulties.

10) QR Code: Scan this QR code to find the Lefun Health APP on your smart device.

11) Turn Off / On : Press and hold the function key on the screen in order to power off the watch. Press and hold the function key on the screen in order to power back on the screen.

Navigating the Lefun Health APP Menu and Features:

Press the menu button on the top left hand corner of the screen in order to start using the APP menu Features.

Connect / Unconnect:

Use this menu to connect or disconnect the smart watch from the APP. In order to connect the smart watch your Bluetooth settings on the smart device must be turned on.

Shake for Selfie:

This will activate the camera on your smart device, once ready to take a picture or selfie simply shake the smart watch in order to snap a photo. For this feature to work be sure to go to the band function settings and make sure the setting for shake for selfie is turned on.

Message Notification:

Here you can choose your message notifications and which messages will be prompted on your smart watch. Simply toggle on / off near the features you want to use; including SMS Reminder (TEXTS), Facebook, Twitter, Whatsapp, LinkedIn and more.

Synchronize all data:

Tap on Synchronize all data to record the latest data from the smart watch into the APP.

Band Function Settings Menu:

• Screen on upon raising:

Turn this feature to the on position in order to activate the screen on the smart watch by either turning or moving your wrist.

• Sedentary Reminder:

Turn this feature on for the smart watch to remind you to get up and walk around if you have been idle for a long time. You can set a time interval to remind you starting every 10 minutes up to 240 minutes.

• Drinking Reminder:

Turn this feature on for the smart watch to remind you to drink. You can set a time interval to remind you starting every 10 minutes up to 240 minutes.

• Shake for Selfie:

Turn this feature on to take selfies / photos in the "Shake for selfie menu".

• Smart Anti-Lost:

Turn this feature on if you want to be able to either find your phone or smart watch if they were misplaced with in range. This feature will only function if the smart watch is connected to your smart devices Bluetooth settings in the APP.

• Smart Alarm:

The APP is equipped with 5 different alarm settings. First turn on the Alarm you want then tap on the time and it will take you to the next screen to set your alarm once set you can choose which days of the week you want to use the same alarm.

• Search Device:

If you misplaced or lost your smart watch and it's still connected to the smart device Bluetooth settings, press on search device and the smart watch will start to vibrate if in range.

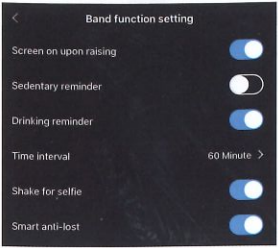

Blue = ON
Black = OFF

IC Statement

This device contains licence-exempt transmitter(s)/ receiver(s) that comply with Innovation, Science and Economic Development Canada's licence-exempt RSS(s). Operation is subject to the following two conditions:

- (1) This device may not cause interference; and
- (2) This device must accept any interference, including interference that may cause undesired operation of the device.

The term "IC: " before the certification/ registration number only signifies that the Industry Canada technical specifications were met. This product meets the applicable Industry Canada technical specifications.

Cet appareil contient des émetteurs / récepteurs exemptés de licence conformes aux RSS (RSS) d'Innovation, Sciences et Développement économique Canada. L'exploitation est autorisée aux deux conditions suivantes : (1) l'appareil ne doit pas produire de brouillage, et (2) l'utilisateur de l'appareil doit accepter tout brouillage radioélectrique subi, même si le brouillage est susceptible d'en compromettre le fonctionnement.

Support

If you have problems with your device, please consult the instructions in this manual.

Manufacturer Warranty

We stand by our products! That's why we guarantee them from any functional defects for one year from the original date of purchase. Should you have an issue please email us at info@GabbaGoods.com or visit us on the web at www.GabbaGoods.com

Distributed by:
M&S Accessory Network Corp.,
New York, NY 10001
Designed in The U.S.A. | Made in China



www.GabbaGoods.com
Technical Support

Keep All Relevant Information for Future Reference.

iPhone, Apple and the Apple logo are trademarks of Apple Inc., registered in the U.S. and other countries. App Store is a service mark of Apple Inc. Android, Google Play, and the Google Play logo are trademarks of Google Inc. IOS is a registered trademark of Cisco in the U.S. and other countries and is used under license. All other trademarks and trade names are those of their respective owners.

Smart Watch Functions:

- Tap on the function key on the screen in order to wake up or activate the screen. Or Raise or turn your wrist and the screen will activate by itself.
- Keep tapping the circle to switch between functions and menus on your smart watch.



How to use the Menu and Features on your smart watch:

- Tap the function key on the screen to switch through the below menu and features.

- 1) Clock: Time and date display, and battery percentage.
- 2) Steps: Number of Steps taken, and calories burned.
- 3) Sports Mode: Press and hold the function key on the screen to activate this feature, then tap the screen to switch between the multiple sports modes including: Run; Badminton; Climb; Ride; once you get to the mode you want press and hold the screen to activate that function. To Pause, Stop or Return to the previous menu tap the screen and then press and hold the function key on the option you want to choose.
- 4) BPM: once the watch is set to the Blood Pressure Monitor screen the smart watch will automatically start to record your blood pressure.
- 5) MMHG: This stands for millimeters of Mercury and is also used to measure pressure, once on this feature the smart watch will automatically start to record your mmHG.

6) SP02: This stand for the estimated amount of oxygen found in your blood, once on this feature the smart watch will automatically start to record your SP02.

7) Find Phone: The smart watch must be connected to the Bluetooth settings on your smart device for this feature to work. To activate this feature press and hold the function key on the screen and you should start to hear an emergency signal on your smart device.

8) Messages: Press and hold the function key to activate your messages. Then tap on the screen to switch through all your messages, including Texts, What's APP, Facebook, Twitter, LinkedIn and more. Only a short notification will be displayed. Please note the entire message will not be visible on the smart watch.

9) About: This screen will show you the software version you are using and is only required if you are having technical difficulties.

10) QR Code: Scan this QR code to find the Lefun Health APP on your smart device.

11) Turn Off / On : Press and hold the function key on the screen in order to power off the watch. Press and hold the function key on the screen in order to power back on the screen.

Navigating the Lefun Health APP Menu and Features:

Press the menu button on the top left hand corner of the screen in order to start using the APP menu Features.

Connect / Unconnect:

Use this menu to connect or disconnect the smart watch from the APP. In order to connect the smart watch your Bluetooth settings on the smart device must be turned on.

Shake for Selfie:

This will activate the camera on your smart device, once ready to take a picture or selfie simply shake the smart watch in order to snap a photo. For this feature to work be sure to go to the band function settings and make sure the setting for shake for selfie is turned on.

Message Notification:

Here you can choose your message notifications and which messages will be prompted on your smart watch. Simply toggle on / off near the features you want to use; including SMS Reminder (TEXTS), Facebook, Twitter, Whatsapp, LinkedIn and more.

Synchronize all data:

Tap on Synchronize all data to record the latest data from the smart watch into the APP.

Band Function Settings Menu:

• Screen on upon raising:

Turn this feature to the on position in order to activate the screen on the smart watch by either turning or moving your wrist.

• Sedentary Reminder:

Turn this feature on for the smart watch to remind you to get up and walk around if you have been idle for a long time. You can set a time interval to remind you starting every 10 minutes up to 240 minutes.

• Drinking Reminder:

Turn this feature on for the smart watch to remind you to drink. You can set a time interval to remind you starting every 10 minutes up to 240 minutes.

• Shake for Selfie:

Turn this feature on to take selfies / photos in the "Shake for selfie menu".

• Smart Anti-Lost:

Turn this feature on if you want to be able to either find your phone or smart watch if they were misplaced with in range. This feature will only function if the smart watch is connected to your smart devices Bluetooth settings in the APP.

• Smart Alarm:

The APP is equipped with 5 different alarm settings. First turn on the Alarm you want then tap on the time and it will take you to the next screen to set your alarm once set you can choose which days of the week you want to use the same alarm.

• Search Device:

If you misplaced or lost your smart watch and it's still connected to the smart device Bluetooth settings, press on search device and the smart watch will start to vibrate if in range.

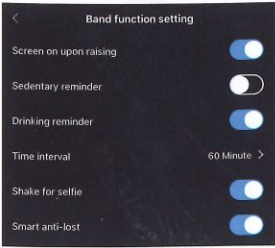

Blue = ON
Black = OFF

IC Statement

This device contains licence-exempt transmitter(s)/ receiver(s) that comply with Innovation, Science and Economic Development Canada's licence-exempt RSS(s). Operation is subject to the following two conditions:

- (1) This device may not cause interference; and
- (2) This device must accept any interference, including interference that may cause undesired operation of the device.

The term "IC: " before the certification/ registration number only signifies that the Industry Canada technical specifications were met. This product meets the applicable Industry Canada technical specifications.

Cet appareil contient des émetteurs / récepteurs exempts de licence conformes aux RSS (RSS) d'Innovation, Sciences et Développement économique Canada. L'exploitation est autorisée aux deux conditions suivantes : (1) l'appareil ne doit pas produire de brouillage, et (2) l'utilisateur de l'appareil doit accepter tout brouillage radioélectrique subi, même si le brouillage est susceptible d'en compromettre le fonctionnement.

Support

If you have problems with your device, please consult the instructions in this manual.

Manufacturer Warranty

We stand by our products! That's why we guarantee them from any functional defects for one year from the original date of purchase. Should you have an issue please email us at info@GabbaGoods.com or visit us on the web at www.GabbaGoods.com

Distributed by:
M&S Accessory Network Corp.,
New York, NY 10001
Designed in The U.S.A. | Made in China



www.GabbaGoods.com
Technical Support

Keep All Relevant Information for Future Reference.

iPhone, Apple and the Apple logo are trademarks of Apple Inc., registered in the U.S. and other countries. App Store is a service mark of Apple Inc. Android, Google Play, and the Google Play logo are trademarks of Google Inc. IOS is a registered trademark of Cisco in the U.S. and other countries and is used under license. All other trademarks and trade names are those of their respective owners.